

02 - Front Suspension / Front / Technical Specifications

TORQUE SPECIFICATIONS

FRONT SUSPENSION

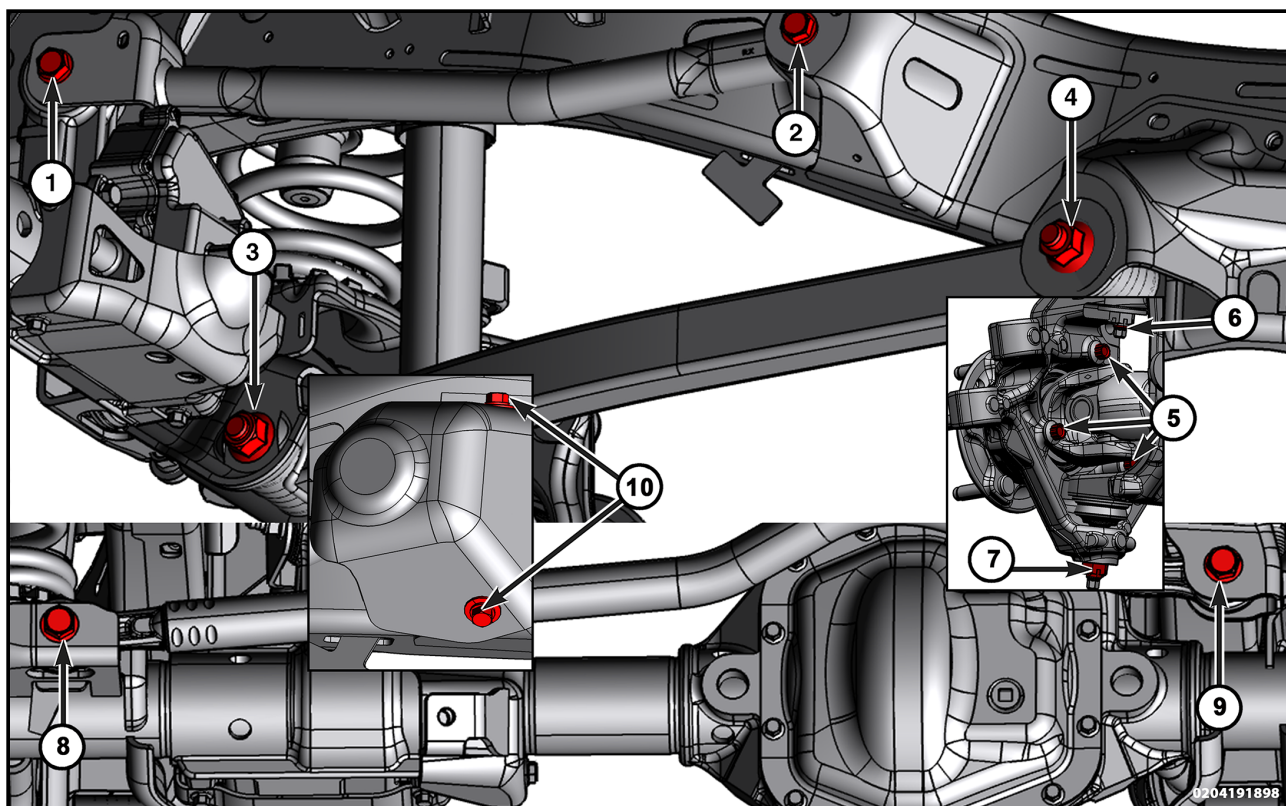

CALLOUT	DESCRIPTION	SPECIFICATION	COMMENT
1	Upper Control Arm Front Bolt	55 N·m Plus 185° (41 Ft. Lbs. Plus 185°)	Fastener must be torqued with the vehicle at normal ride height.
2	Upper Control Arm Rear Bolt	150 N·m Plus 95° (111 Ft. Lbs. Plus 95°)	Fastener must be torqued with the vehicle at normal ride height.
3	Lower Control Arm Front Nut	140 N·m Plus 145° (103 Ft. Lbs. Plus 145°)	Fastener must be torqued with the vehicle at normal ride height.
4	Lower Control Arm Rear Nut	140 N·m Plus 145° (103 Ft. Lbs. Plus 145°)	Fastener must be torqued with the vehicle at normal ride height.
5	Hub And Bearing Bolts	102 N·m (75 Ft. Lbs.)	—
6	Upper Ball Joint Nut	75 N·m (55 Ft. Lbs.)	Once final torque is reached, manually advance the castle nut to the next castle opening for the cotter pin to be inserted, even if the hole is aligned when final torque is reached.

CALLOUT	DESCRIPTION	SPECIFICATION	COMMENT
			Do not reuse the cotter pin. If removed, a new cotter pin must be installed.
7	Lower Ball Joint Nut (aluminum knuckle) (initial torque) "Early" NON induction hardened ball joint W/O "IH" marking on the ball joint.	20 N·m (15 Ft. Lbs.)	–
7	Lower Ball Joint Nut (aluminum knuckle) (final torque) "Early" NON induction hardened ball joint W/O "IH" marking on the ball joint.	80 N·m (59 Ft. Lbs.)	Once final torque is reached, manually advance the castle nut to the next castle opening for the cotter pin to be inserted, even if the hole is aligned when final torque is reached. Do not reuse the cotter pin. If removed, a new cotter pin must be installed.
7	Lower Ball Joint Nut (aluminum knuckle) (initial torque) Induction hardened ball joint with "IH" marking on the ball joint.	20 N·m (15 Ft. Lbs.)	–
7	Lower Ball Joint Nut (aluminum knuckle) (final torque) Induction hardened ball joint with "IH" marking on the ball joint.	80 N·m (59 Ft. Lbs.)	Once final torque is reached, manually advance the castle nut to the next castle opening for the cotter pin to be inserted, even if the hole is aligned when final torque is reached. Do not reuse the cotter pin. If removed, a new cotter pin must be installed.
7	Lower Ball Joint Nut (cast iron knuckle) (initial torque) "Early" NON induction hardened ball joint W/O "IH" marking on the ball joint.	30 N·m (22 Ft. Lbs.)	–
7	Lower Ball Joint Nut (cast iron knuckle) (final torque) "Early" NON induction hardened ball joint W/O "IH" marking on the ball joint.	65 N·m (48 Ft. Lbs.)	Once final torque is reached, manually advance the castle nut to the next castle opening for the cotter pin to be inserted, even if the hole is aligned when final torque is reached. Do not reuse the cotter pin. If removed, a new cotter pin must be installed.
7	Lower Ball Joint Nut (cast iron knuckle) (initial torque) Induction hardened ball joint with "IH" marking on the ball joint.	30 N·m (22 Ft. Lbs.)	–
7	Lower Ball Joint Nut (cast iron knuckle) (final torque) Induction hardened ball joint with "IH" marking on the ball joint.	65 N·m (48 Ft. Lbs.)	Once final torque is reached, manually advance the castle nut to the next castle opening for the cotter pin to be inserted, even if the hole is aligned when final torque is reached.

CALLOUT	DESCRIPTION	SPECIFICATION	COMMENT
			Do not reuse the cotter pin. If removed, a new cotter pin must be installed.
8	Track Bar Axle Bolt	70 N·m Plus 155° (52 Ft. Lbs. Plus 155)	-
9	Track Bar Frame Bolt	70 N·m Plus 115° (52 Ft. Lbs. Plus 115)	-
10	Heat Shield Bolt	70 N·m Plus 115° (52 Ft. Lbs. Plus 115)	-

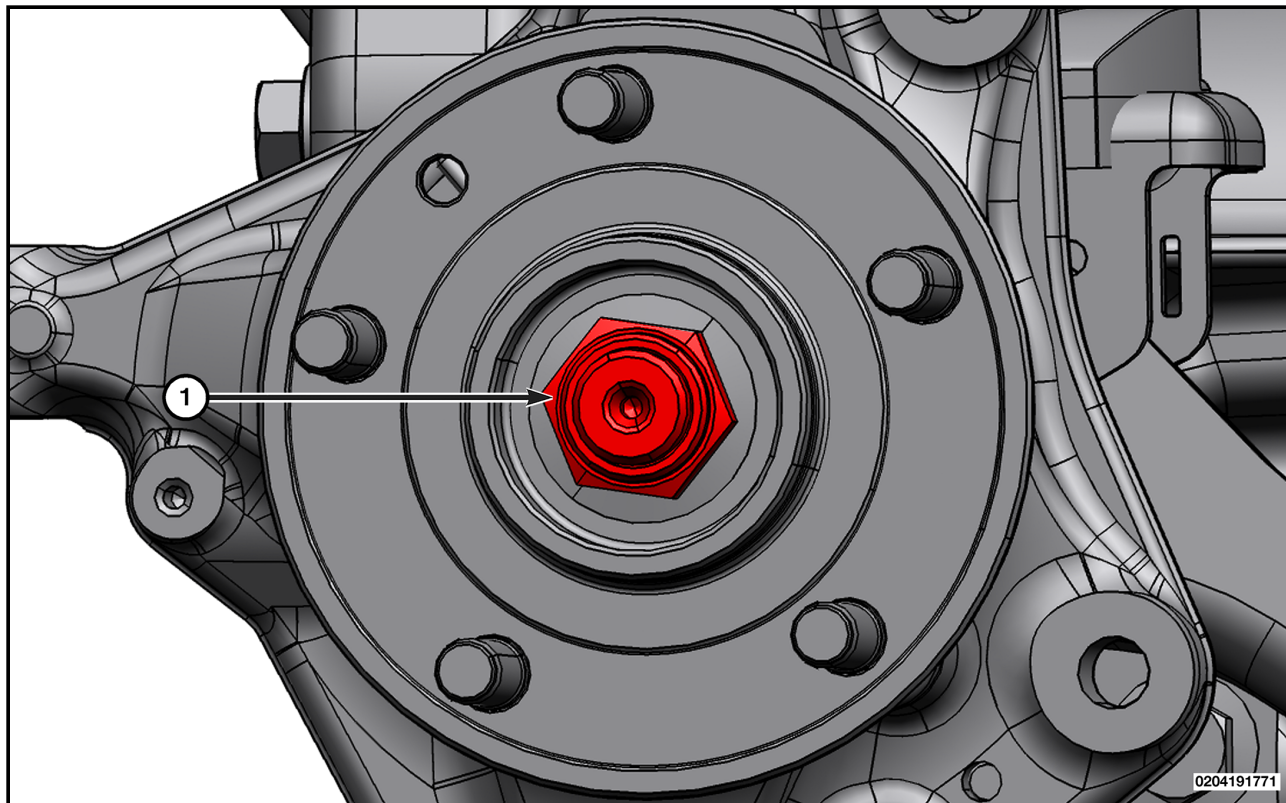

CALLOUT	DESCRIPTION	SPECIFICATION	COMMENT
1	Hub And Bearing Nut	136 N·m (100 Ft. Lbs.)	-

+ SHOCK ABSORBERS

+ FRONT STABILIZER BAR