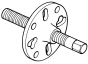
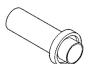

REMOVAL AND INSTALLATION

Primary LOP	Related LOP	Description	Skill Level	Skill Category
21 03 20 06	-	Seal, Rear Output Seal,extension housing	1 - Semi Skilled	3

Special Tools:

[Click here to launch the form to order any tools you need.](#)

	<p>C-3281 - Holder, Flange Originally Shipped In Kit Number(s) 9202, 9202A-CAN, 9202CC, 9299, 9299CC, 9299CC, 9300A-CAN.</p>
	<p>C-452 - Puller, Companion Flange</p>
	<p>6952A - Installer, Seal Originally Shipped In Kit Number(s) 6945, 6947, 6949.</p>

REMOVAL

NOTE: Rear output seal shown, front output seal similar.

1. Raise and support the vehicle (Refer to 04 - Vehicle Quick Reference/Hoisting/Standard Procedure).
2. Remove the appropriate propeller shaft (Refer to 03 - Differential and Driveline/Propeller Shaft/Removal and Installation).
3. Install two bolts (2) partially in the propeller shaft companion flange (3), 180° from each other.
4. Install the rectangular end of the [C-3281](#) (1) over the bolts to hold the companion flange stationary and remove the nut holding the companion flange to the output shaft.

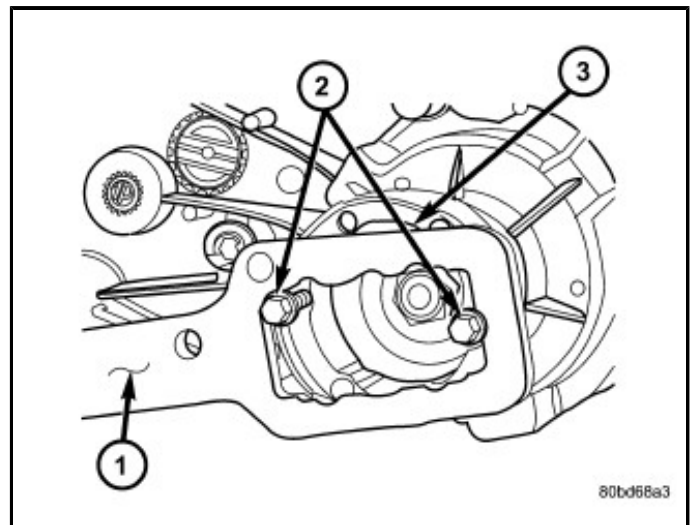

- Using the [C-452](#) (3) remove the companion flange (2) from the assembly (1).

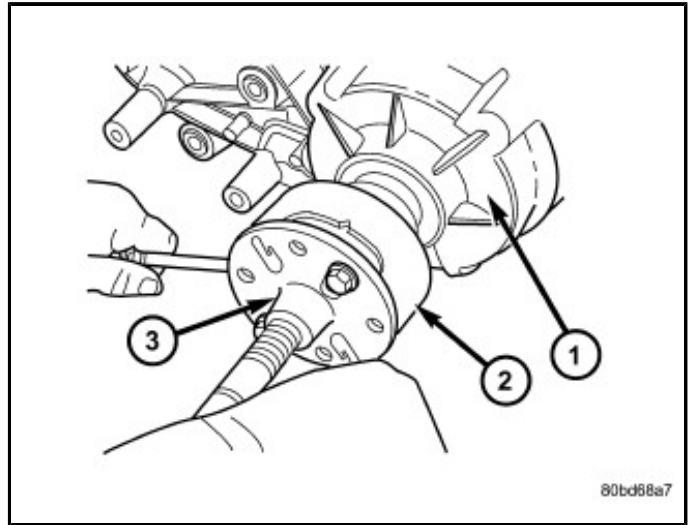

Front output seal shown, rear output seal similar.

- Remove the output shaft seal (1) .

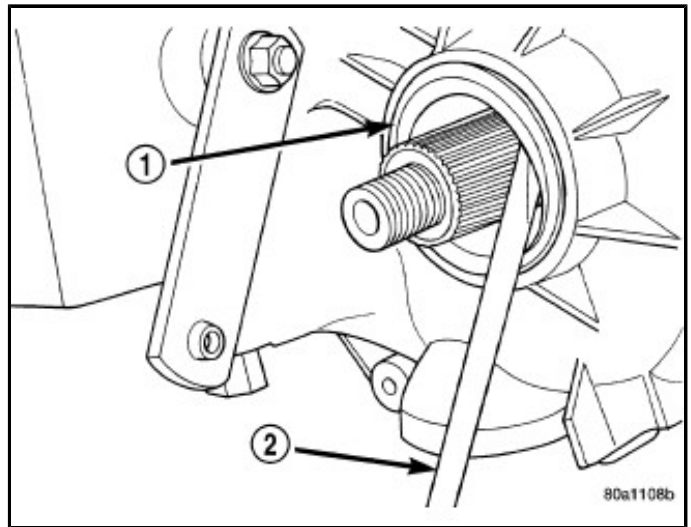

INSTALLATION

Front output seal shown, rear output seal similar.

- Install a **NEW** output seal in the case (2) with Seal Installer [6952A](#) (1) as follows:

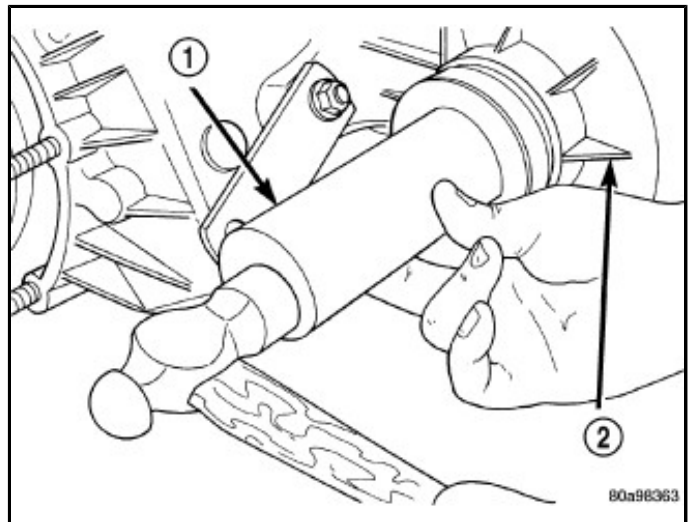

- Install the output shaft companion flange (2). Tighten the companion flange nut (1) to the proper (Torque Specifications).

3. Install the appropriate propeller shaft (Refer to 03 - Differential and Driveline/Propeller Shaft/Removal and Installation).
4. Check the fluid level, if the fluid is low, fill the transfer case with the specified fluid (Refer to 04 - Vehicle Quick Reference/Capacities and Recommended Fluids/Specifications).
5. Remove the support and lower the vehicle.